



# ENHANCING A VITAL CONNECTION

## THE ROUTE 92 CENTENNIAL BRIDGE REPLACEMENT PROJECT

In 2014, the Kansas Department of Transportation (KDOT), in coordination with the City of Leavenworth, Kansas, initiated an Advanced Preliminary Engineering (APE) study to determine the future of Centennial Bridge. In service for 60 years, and having only two lanes, the bridge was already outdated. After conducting additional research and inviting public feedback, the decision was made to replace the bridge with a more modern river crossing just to the north. The new bridge will expand vehicle capacity, add resources for pedestrians and cyclists, improve river features, and continue the Centennial Bridge legacy.

### BENEFITS OF THE NEW BRIDGE INCLUDE:



The new bridge will not be tolled.



Doubling the number of traffic lanes.



Improving flood resilience in the area.



Providing combined use pedestrian and bicycle accommodations.



Resolving Missouri River navigation challenges.

## A NEW CENTENNIAL

To make the new Centennial Bridge a reality, KDOT collaborated with the Missouri Department of Transportation (MoDOT). KDOT and MoDOT then brought on engineering consulting firms HDR Inc. and TranSystems to advance bridge and roadway design, and conduct environmental and traffic studies, river analysis, and public and stakeholder outreach.

Throughout 2022, the project team sought input from local stakeholders, including leaders from the City of Leavenworth and Leavenworth County, Kansas, US Army Garrison Fort Leavenworth, local utilities, municipal departments, railway companies, and local businesses and enterprise organizations.

On behalf of our entire project team, thank you for supporting this important initiative!



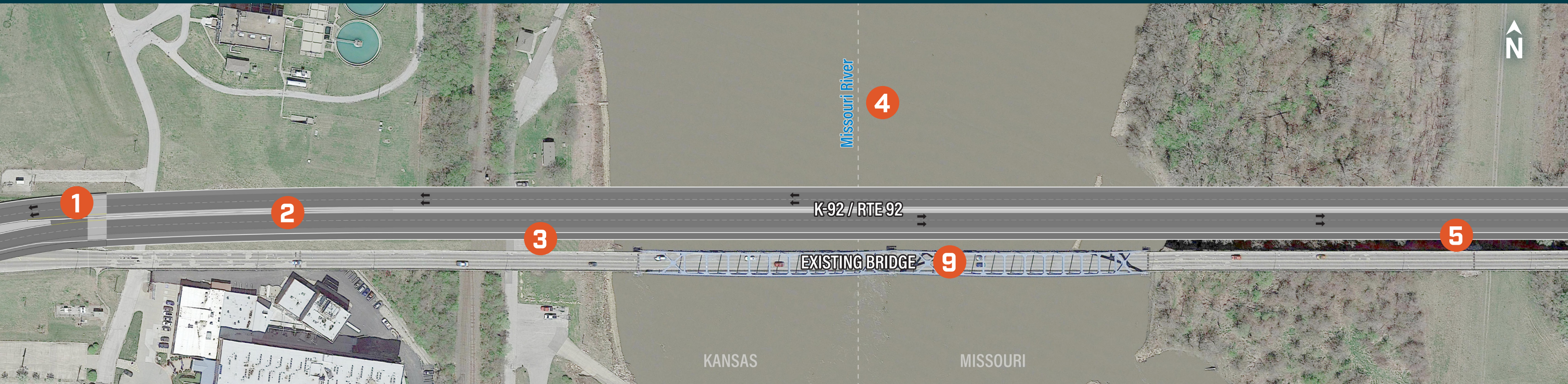

## PROJECT HIGHLIGHTS

- 1** Increased safety and efficiency by expanding to four lanes.

**2** Center traffic barrier includes top-railing for driver visibility.

**3** Dedicated pedestrian and cycling pathway with overlooks.

**4** Designed to improve Missouri River navigation and flood resilience.

**5** Pedestrian and bicycle path enables future trail or resource connections.
- 6** Expansion of Sherman Ave. and 4th St. intersection to accommodate expanded bridge traffic.

**7** Gradual alignment change to meet new bridge.

**8** New northern bypass lane to relieve roundabout traffic.

**9** With the exception of limited, temporary closures, the existing bridge will remain open as the new bridge is constructed.

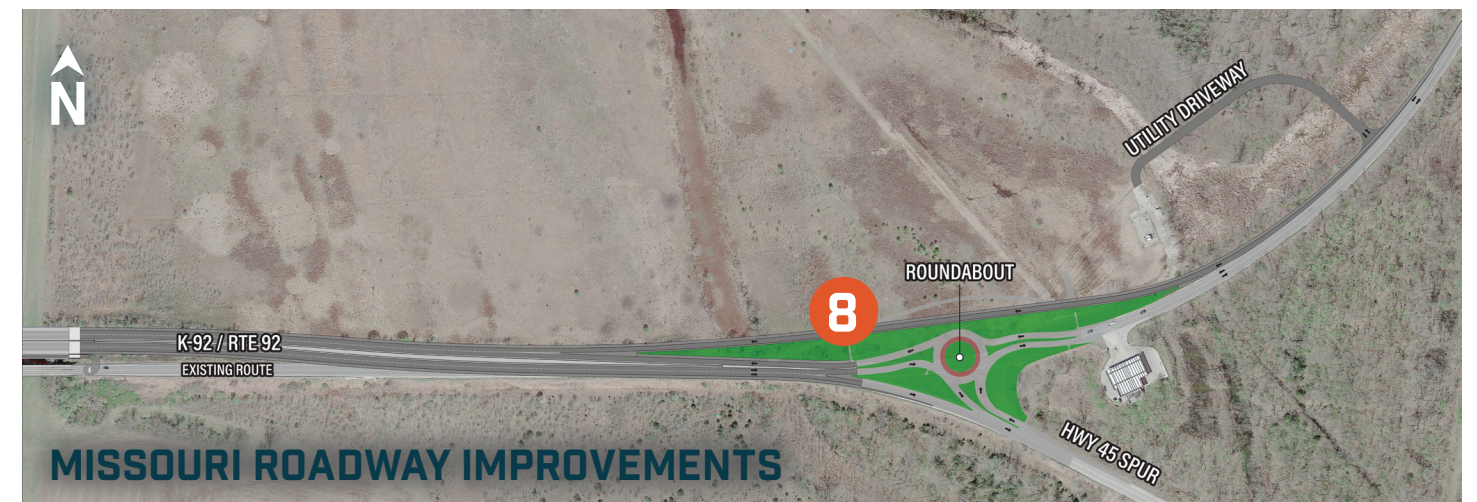
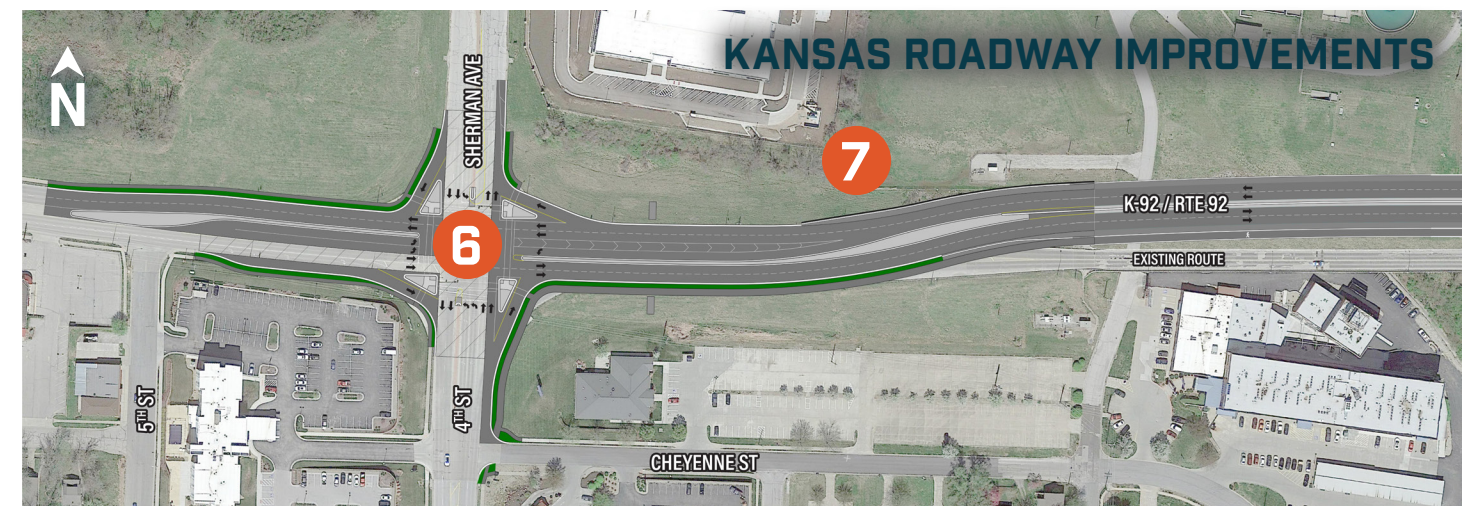

# THE FIRST CITY'S BRIDGE

Starting with the preliminary study in 2014, public and stakeholder input has been an important factor in the planning and design of the new Centennial Bridge. The community feedback provided to KDOT, MoDOT, HDR Inc. and TranSystems has been used to better understand the City of Leavenworth's connection to the river crossing and its historic connection to the past. From traffic patterns to color preferences to utility relocations, the project team has endeavored to design a new bridge that is befitting the first city of Kansas.

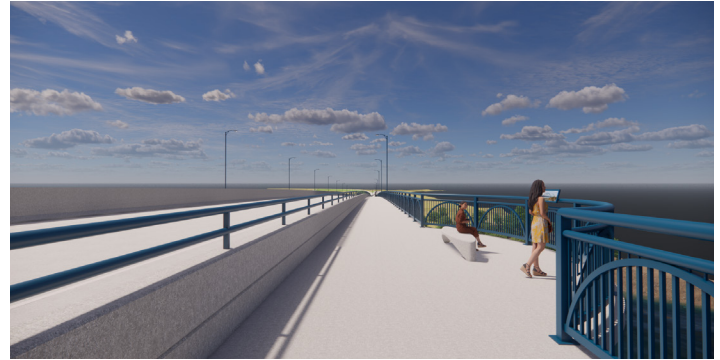

All bridge renderings are preliminary and subject to change

## ANTICIPATED TIMELINE

2023

**FEBRUARY**

★ Public Meeting

**MAY**

Environmental (NEPA) Public Hearing

**OCTOBER**

Field Review

2024

**JANUARY**

Begin Right-of-Way Activities

2025

**2025**

Continue Right-of-Way Activities

2026

**APRIL**

★ Complete Right-of-Way Activities

**JUNE**

★ Design Complete

**AUGUST**

Bid Letting\*

2027

**EARLY 2027**

★ Construction Begins\*

2028

2029

**2029**

Construction Complete\*

★ New Centennial Bridge Opens\*

Old Centennial Bridge Demolished\*

★ Key Milestone

\*Tentative date shown pending approval for construction



**LEARN MORE AND STAY CONNECTED**

📞 913.766.2198

@ connect@newcentennialbridge.org

🌐 newcentennialbridge.org